

Proposed rear (north) elevation.

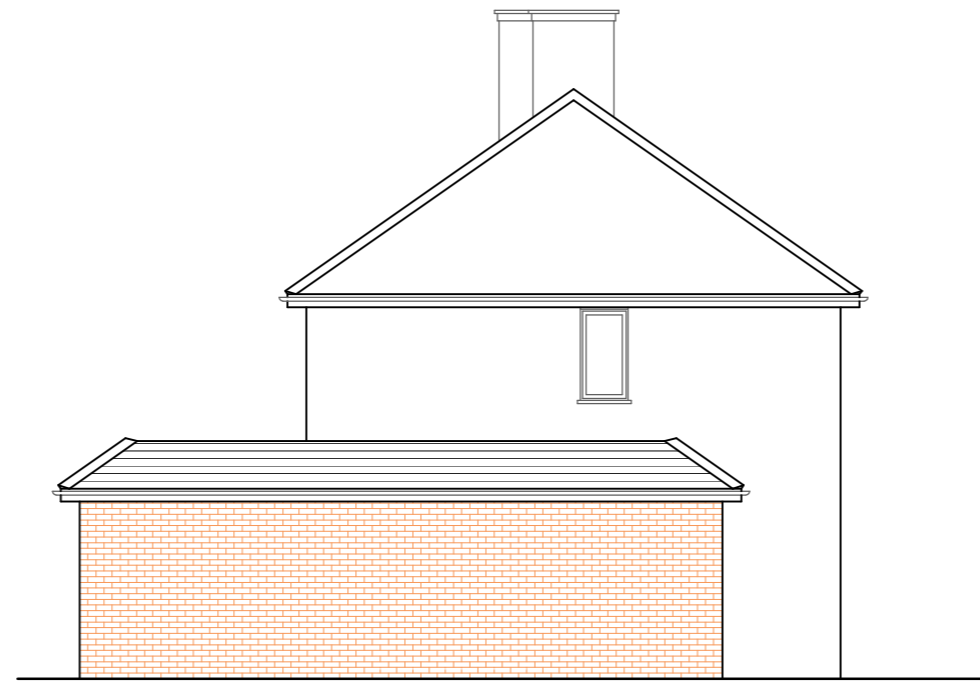

Proposed side (west) elevation.



Proposed front (south) elevation.

Proposed materials.

Walls to be face brickwork to match the existing house.
 Roof and dormer tiled to match the existing roof.
 The part flat roofed area of the proposed dwelling to be grey fibreglass finish.
 Windows and doors are to be white PVCu frames with double glazed panes.

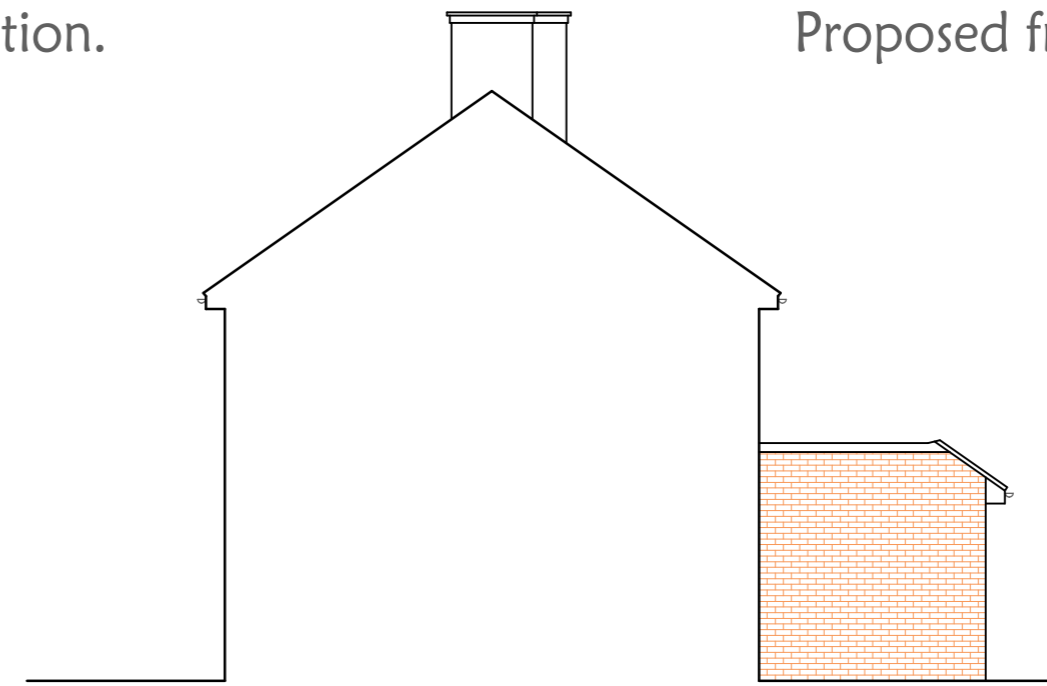

Proposed side (east) elevation.

Proposed PV panels in accordance with Falcon Energy requirements.

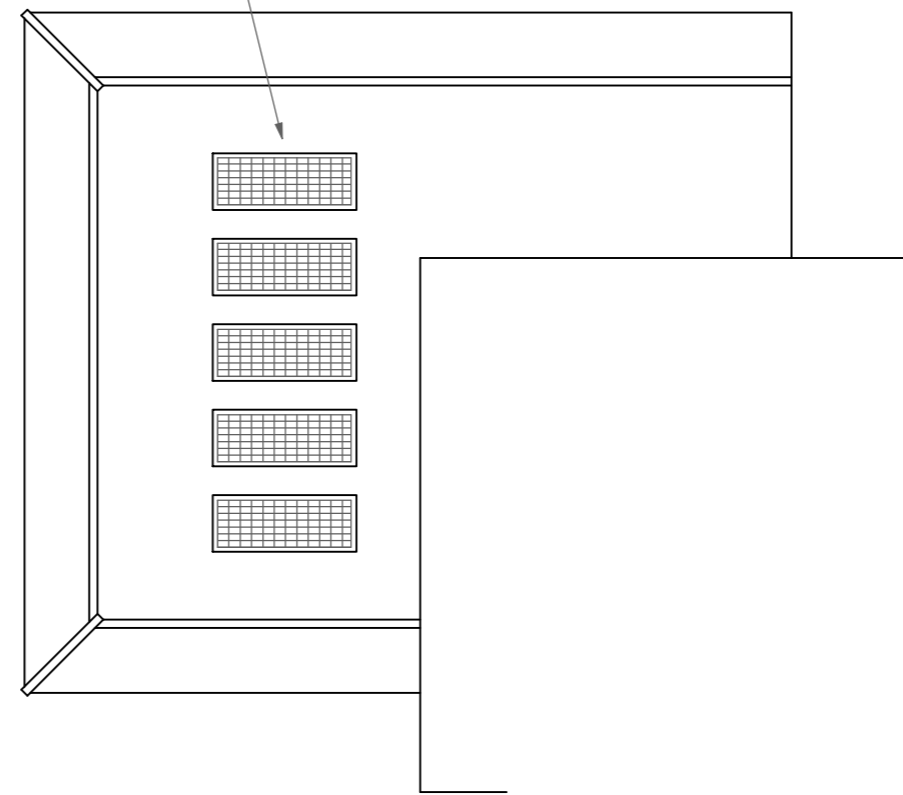

Proposed roof plan.

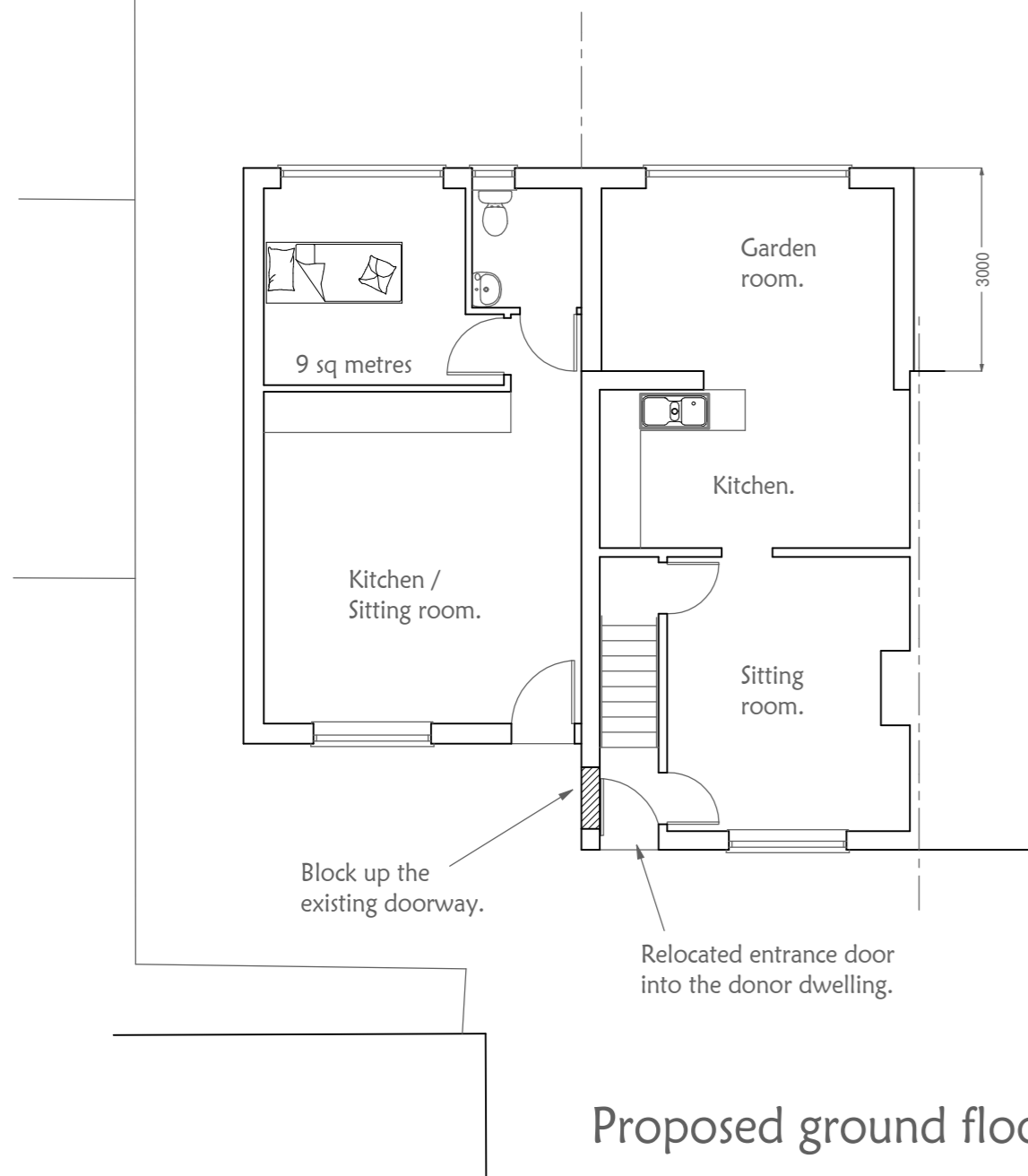

Proposed ground floor plan.

Rev.	Description.	Date.
B.	Bedroom reduced in size.	14/6/21
A.	Revised to suit planning department comments on previous application.	17/9/20

Plans2build

Jolly Lane Cottage
 Hexworthy
 Princetown
 Yelverton
 Devon PL20 6SD

Tel 01364 631031 Mob 07932 085309
 E-mail design@plans2build.com
 Website: www.plans2build.net
 Architectural & Structural Consultants

Client Mr D Steers.
 address 21 Neath Gardens, Morden, SM4 6JN.

site address

scale. 1:100 date. March 2020

Proposed plans & elevations.

Drawing No. 20/12/02 B.

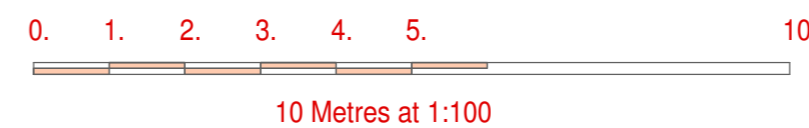

This page is intentionally left blank